



PowerTank F Series Line Interactive UPS

The PowerTank F Series uses a line interactive topology UPS which comes with a simulated sinewave output and an LCD panel to display information such as input voltage, output voltage, battery capacity, load level, and UPS fault.

This UPS comes with UPS power management software (Optional). It allows remote monitoring and management of one to multiple UPSs in a networked environment, either LAN or Internet, to prevent data loss from power outages and safely shutdown systems, but also stores programming data and scheduled shutdown UPSs. It comes with optional PowerMaster Cloud subscription-based software for UPS monitoring via cloud capability.

Features

- User Friendly LCD Display
- Built-in AVR for Voltage Stabilization
- High Quality SLA Maintenance Free Battery
- Cold Start Function
- Off-mode Charging
- Built-in EMI/RFI Noise Filter
- Lightning, Spike & Surge Protection
- Modem/Fax/Network Line Protection (RJ11/RJ45)
*Optional
- Comes with USB Port & Power Management Software
*Optional
- PowerMaster Cloud Software for UPS monitoring via
Cloud Capability *Optional



Personal
Computer



POS
System



Home
Theatre System



Cloud
Technology



Key Advantages

LCD Display

LCD display shows information such as input voltage, output voltage, battery capacity, load level and UPS status.

Output Socket

Comes with 3 or 4 x 13Amp British Output Socket c/w Safety Window

Built-in AVR

Built-in AVR for voltage stabilization to provide clean and stable power to connected equipment. AVR features help to correct high and low voltage without using battery power

Cold Start Function

The UPS can be turned on with battery alone without input connected to grid.

Data Line Protection (RJ11/RJ45)*Optional

The data line protection safeguards modem, fax or network line against surge or spike

Power Management Software *Optional

Come with USB Port interfaces to support UPS Power Management Software

PowerMaster Cloud Software *Optional

PowerMaster Cloud is a subscription-based software that adopts the client-server architecture, allowing users to remotely access the system through a web browser or APP on a smart phone. It consists of a UPS, PowerMaster Cloud software, or a Cloud management card that collects detailed information from each UPS and sends it to the Power Master Cloud server. Users can manage multiple UPS with one user account.

PowerMaster Cloud software can be used in two ways:

- i. Power Management with PowerMaster Cloud Software
UPS management system via USB or Serial Port which requires a standby computer installed with "Power Master Cloud" software. Through network connection from the standby computer, the users can monitor the UPS via Cloud website or Cloud APP.
- ii. Power Management with CMCARD
By installing CMCARD to the UPS and connecting with the network.

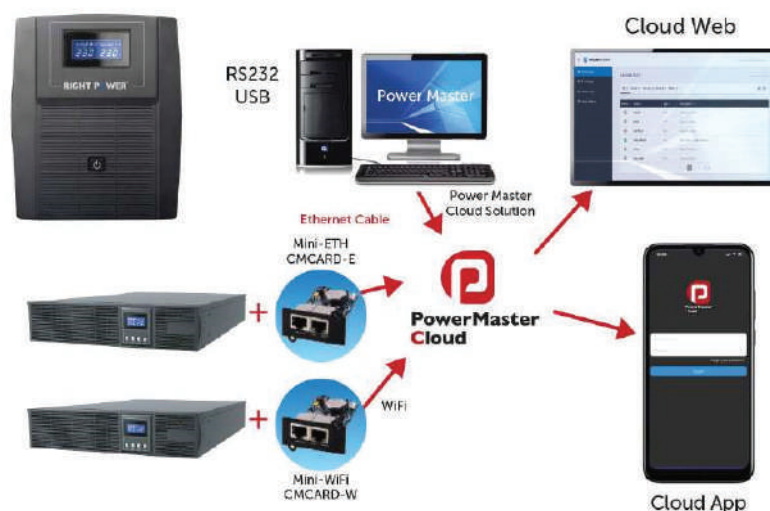

*Specification subjects to change without prior notice

Rear Panel

800VA



PowerTank F 800

- 1. AC Input
- 2. 13Amp British Output Socket c/w Safety Window



PowerTank F 800P

- 3. USB Port

Rear Panel

1000VA - 2200VA



PowerTank F 1000E

- 1. AC Input
- 2. 13Amp British Output Socket c/w Safety Window
- 3. USB Port



PowerTank F 1000P - 2200P

- 4. RJ 11/ RJ45 Port
- 5. Circuit Breaker
- 6. Cooling Fan



Technical Specification:

MODEL	PowerTank F800	PowerTank F800P	PowerTank F1000E	PowerTank F1200P	PowerTank F1500P	PowerTank F2200P
CAPACITY (VA)	800VA	800VA	1000VA	1200VA	1500VA	2200VA
INPUT						
INPUT VOLTAGE	220V / 230V / 240V					
VOLTAGE RANGE	162 - 290VAC					
FREQUENCY RANGE	50Hz or 60Hz					
OUTPUT						
OUTPUT VOLTAGE	220V / 230V / 240V					
AC VOLTAGE REGULATION (Batt. Mode)	± 10%					
OUTPUT FREQUENCY	50Hz or 60Hz +/- 1%					
WAVEFORM	Simulated Sinewave					
TRANSFER TIME (Typical)	4ms					
OUTPUT SOCKET	3 x 13Amp British Socket c/w Safety Window			4 x 13Amp British Socket c/w Safety Window		
BATTERY						
SEALED LEAD ACID MAINTENANCE FREE	12V 7AH x 1	12V 7AH x 1	12V 9AH x 1	12V 7AH x 2	12V 9AH x 2	12V 9AH x 2
BACKUP TIME (Depending on load)	20 to 30 minutes					
RECHARGE TIME	4 - 6 hours to 90% After Complete Discharge					
STATUS INDICATOR						
LCD DISPLAY	Input Voltage , Output Voltage, Battery Capacity, Load Level, UPS Status					
AUDIBLE ALARMS	On Battery, Low Battery, Overload, UPS Fault					
COMMUNICATION						
POWER MANAGEMENT SOFTWARE	N/A	Support Windows Family, Linux & MAC	N/A	Support Windows Family, Linux & MAC		
POWER MASTER CLOUD SOFTWARE (SUBSCRIPTION)				HID Compliant USB Port		
INTERFACE				HID Compliant USB Port		
SURGE PROTECTION & FILTERING						
EMI/RFI NOISE FILTER	Yes					
LIGHTNING/SURGE PROTECTION	Yes					
OVERLOAD PROTECTION	Yes. Breaker / Fuse					
MODEM / FAX / TEL LINE & NETWORK PROTECTION	N/A			RJ 11 / RJ 45 (1in 1out)		
PHYSICAL						
OPERATING ENVIRONMENT	0-40°C, 0-90% Relative Humidity (Non-Condensing)					
NOISE LEVEL	Less Than 40dB			Less Than 45dB		
DIMENSION (D x W x H)mm	286 x 96 x 138			298 x 148 x 178		
WEIGHT (KG)	4.8	4.8	6.5	8.7	9.1	10.8
WARRANTY						
UPS WARRANTY	3 Years Full Warranty Include Parts & Labour					
	2 Years Warranty for Battery					

*Specification subjects to change without prior notice