

Reolink TrackMix WiFi

# 4K Dual-Lens PTZ Camera with Motion Tracking

- Wide-Angle & Telephoto Lenses
- Dual View, Dual Tracking
- 4K 8MP Ultra HD
- 2.4/5Ghz Dual-Band WiFi



# TrackMix: Dual Lens | Dual View | Dual Tracking

- **Big Picture & Big Details**

The dual-lens camera captures both full-view and close-up images of the same event synchronously, and presents them on the same screen!

- **Auto Track & Auto Focus**

The dual-tracking camera can pan, tilt (up to 355° H, 90° V) to auto track the object and show it in both the panoramic and zoomed views.



# 4K Brings You Closer to Reality

The camera with 4K 8MP Ultra HD resolution captures images with great details. Discover more when zooming in.

The video was captured by camera's wide-angle lens.



# Smart Detection & Two-Way Audio

TrackMix WiFi can distinguish people, vehicles and pets\* from other objects, providing more accurate alerts. Plus, you can talk back via the camera's built-in mic and speaker.

**\*Note: Currently, the pet detection is used to detect dogs and cats and is in beta testing.**

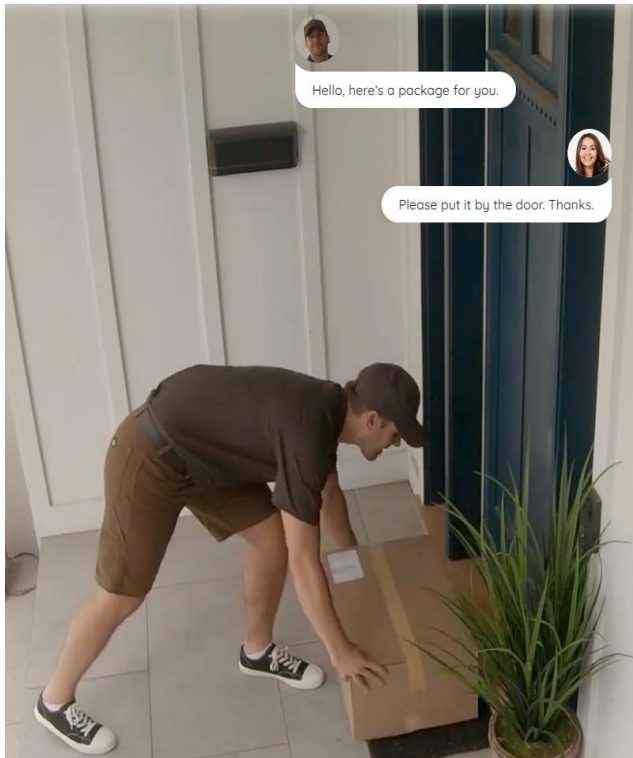

Person Detection

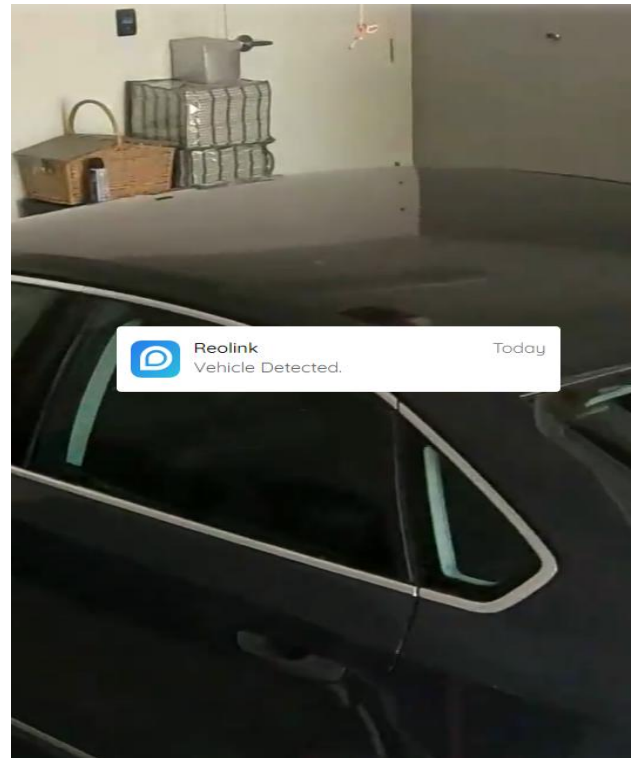

Vehicle Detection

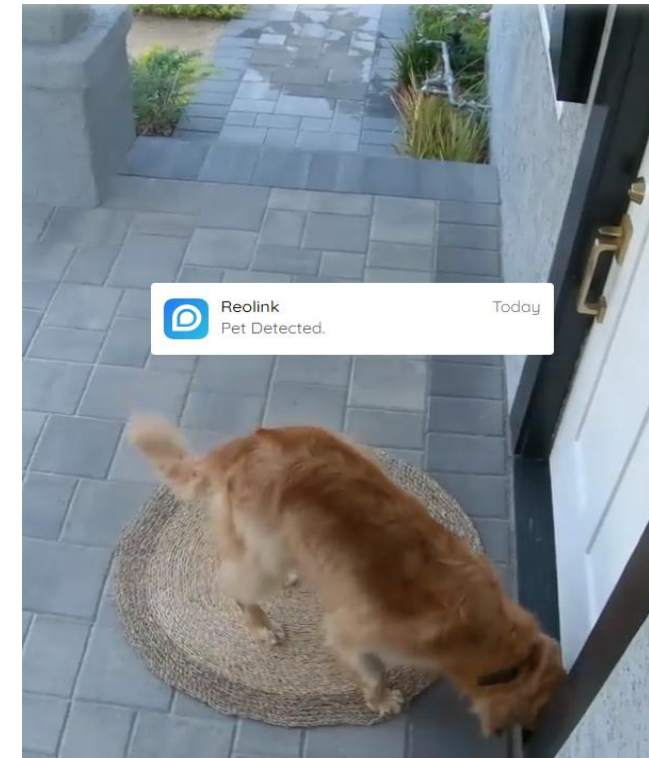

Pet Detection (beta)\*

## Two Night Vision Modes

When its spotlights are on, TrackMix WiFi provides full-color night vision. Even when there's no light at all, its infrared LED still enables high-quality night recording videos.



# Dual-Band WiFi

TrackMix WiFi supports both 2.4GHz and 5GHz (5.8GHz) frequencies to ensure stronger signal and more smooth live view. Flexible to choose, easy to set up.

2.4 GHz / 5 GHz

Dual-Band WiFi

2T2R

MIMO Antennas





## Stay Strong, Stay Weatherproof

The rugged housing and body make this Reolink smart IP camera waterproof. It works perfectly both inside and outside your house, in any harsh weather conditions.



# Multiple Recording Options

This smart IP camera supports 24/7 continuous, motion-triggered, or scheduled recordings. All the videos can be saved to the micro SD card, Reolink NVR or FTP server. Choose a way you like and enjoy customized security.



## Micro SD Card

Supports up to 256GB micro SD card (not included).



64GB



128GB



256GB

Figure based on the default bit rate of the cam (6144 kbps). Actual recording time depends on the settings. Results may vary. [Learn more](#) >

## Reolink NVR

If you want to save videos for a much longer time or manage multiple cameras, you can simply connect this camera to a [compatible Reolink NVR](#) or [security camera system](#).

*\*Reolink NVRs are recommended for best performance. Also, the NVR firmware must be updated for dual-view displaying.*

[Check its compatible NVRs](#) >

[Customize your security camera system](#) >

[Add WiFi cam to Reolink PoE NVR](#) >



# Make Everything Even Easier

Via Reolink App or Client, home security is conveniently connected to your life.

## Real-Time Motion Tracking & Alerts

Once it detects the suspicious object, the camera will auto track it and send to your device an instant push notification.



## Dual View, Live View

Live view what's happening with both the wide-angle view and the close-up view on the same screen. Easy and intuitive.

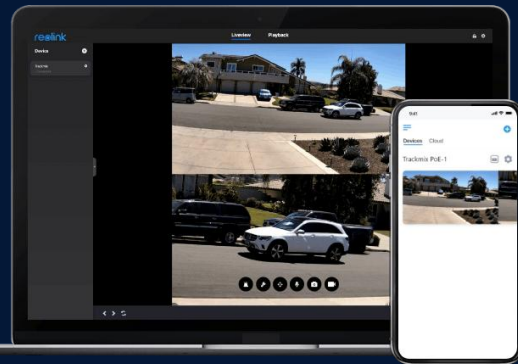

## Easy & Smart Playback

You can replay the saved videos, filter them by detection modes and control the timeline to quickly locate what you want to see.



## Customized Motion Zone

You can customize the motion zone to your liking, deciding where objects' movements will be detected and where they will not.

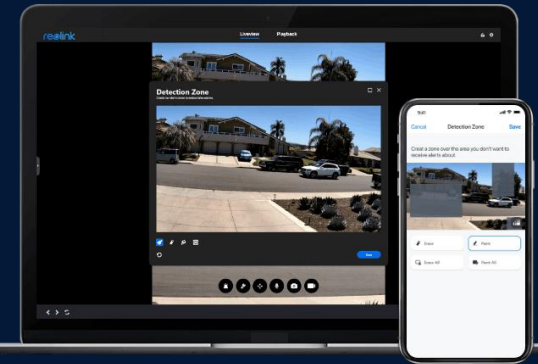

# Control Your Cameras , Hands-Free

As easy as saying “Hey Google, show me the backyard”, you can check what’s happening there on your Google Nest Hub or Chromecast-enabled TVs.



Control it with your voice. Just ask Alexa to show the video of your camera on the Echo Spot, Echo Show or Fire TVs, and everything is done.



\* Note: Only its wide-angle view supports Google Assistant, which is incompatible when camera is connected to NVRs.

# Product Specs



1. Infrared LED

2. Lens

3. Mic

4. Daylight Sensor

5. Spotlight

1. Micro SD Card Slot

2. Reset Button

# Product Specs

## Video & Audio

---

Image Sensor	1/3" + 1/2.8"
Default Video Info	3840X2160(8Megapixels)@25FPS 1920X1080(2Megapixels)@20FPS
Lens	f=2.8mm, F=1.6 H:104° V:60° f=8mm, F=1.6 H:38° V:21°
Zoom	6X Mix
Video Format	H.265/H.264
Field of View	Horizontal: 104°-38°, Vertical: 60°-21°
Pan/Tilt Angle	Pan: 355°;Tilt: 90°
Day&Night	Auto-switching IR-cut filter
Infrared Night Vision	30m (LED: 2pcs/20mil/850nm)
Spotlight	2pcs/6500K/450 Lumens/15m/4W
Audio	Built-in Microphone and Speaker

## Interface

---

Power	DC 12V/2A
System	Reset Button
Network	One 10M/100Mbps RJ45
Storage	Micro SD Card Slot (support up to 256GB micro SD card); Reolink NVR

## Software

---

Frame Rate	2-25FPS
Code Rate	Wide Angle: MAIN:4096-8192Kbps default: 4096kbps Sub:128-1228Kbps default: 768kbps Tracking: MAIN:3072Kbps sub: default: 768kbps
Browsers Supported	Edge, Chrome, Firefox, Safari
OS Supported	PC: Windows, Mac OS; Smartphone: iOS, Android
Smart Alarm	Motion Detection AI Detection
Record Mode	Motion Recording; Schedule Recording; 24/7 Recording
Protocols & Standards	HTTPS, SSL, TCP/IP, UDP, HTTP, IPv4, UPnP, RTSP, RTMP, SMTP, NTP, DHCP, DNS, DDNS, FTP, P2P
Maximal User Access	20 users (1 admin account & 19 user&administrator accounts); supports up to 12 simultaneous video streams (10 substreams & 2 mainstreams)
Linked Devices	√
Work with	Google Assistant

# Product Specs

## AI

AI Human Detection	√
Car	√
Pet	√
Auto Tracking	√

## Wi-Fi

Wireless Standard	IEEE 802.11a/ b/g/n
Operating Frequency	2.4 GHz/5GHz
Wireless Security	WPA/WPA2

## Working Environment

Temperature	-10°C~+55°C
Humidity	10% ~ 90%
Waterproof	Waterproof

## Size & Weight

Dimension	228 x 147 x 129mm
Weight	1.211kg

## Certifications

FCC,IC,CE,UKCA,RCM,RoHS,REACH,CP65



## Multiple Storage Options



## What's in the box

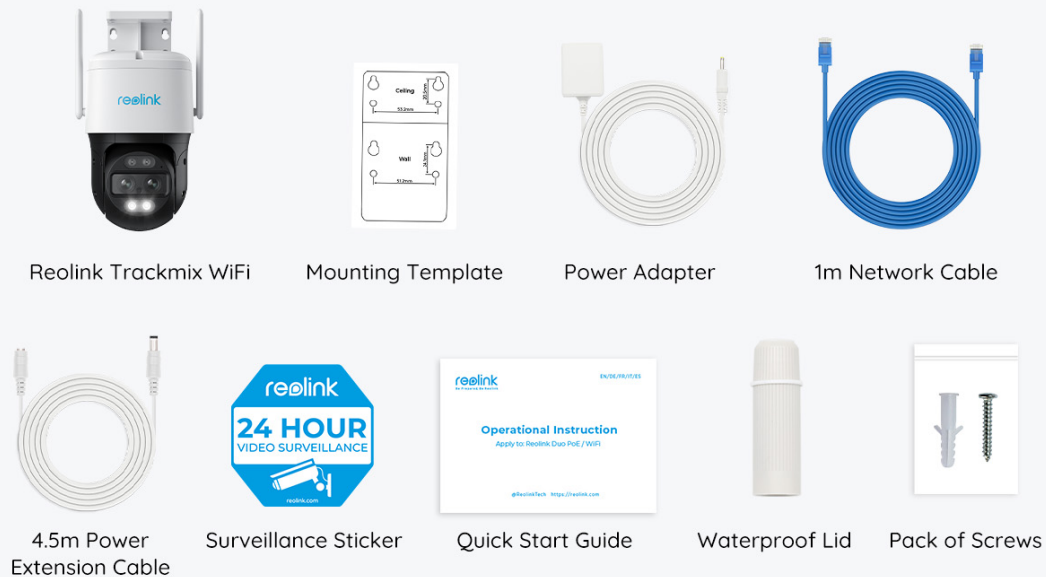

Works with Reolink NVR



Work with FTP



**H.265**  
Video Coding



**H.265**

H.264

reolink

[www.reolink.com](http://www.reolink.com)