



Receiver



Transmitter

Receiver

Plug the receiver into the outlet. The receiver will perform better if kept away from other electrical equipment (eg TV, microwave etc.). Try and locate the receiver in a clear line of sight to the bell push, if you are experiencing signal problems try another location as something could be interfering with it.

Transmitter

Clean the surface where you intend to mount the transmitter and the back of the transmitter. Before mounting the transmitter, please run a test. Put receiver and transmitter where you want to mount. Close all doors when you test. If the receiver does not sound, please see Trouble Shooting section.

Mounting the transmitter with screw

1. Place the bell push mounting bracket on the required location of the wall and carefully secure with the fixing screws provided.
2. Carefully push the bell push down onto the mounting bracket until it locks into place.

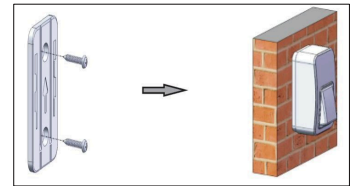

Mounting the transmitter with adhesive pad

1. Clean the area thoroughly before trying to secure the bell push.
2. Stick the adhesive pad supplied directly to the back of the bell push and press it onto your required location. Do not use the mounting bracket when using the self-adhesive pad.

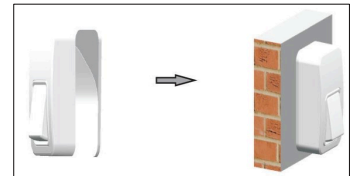

Products Details

Specification	Receiver	Transmitter
Power supply	AC 100-240V	Self-powered
Operating temperature	-10°C to +40°C	-20°C to +50°C
Working range	80m open area	
RF frequency	433MHz	
Sound level	85dB max	-
Power Consumption	<280mW	-
Waterproof	-	IPX7
Operating Force	-	10N
Dimension	78 x 50 x 65 mm	79 x 44 x 32 mm
Weight	75g	62g

Operating Instructions



- A** Indicator Light
- B** Button **B**
- C** Button **C**

- Adjust sound volume - Short press button A on the side of the unit to cycle through 3 volume levels.
- Silent Mode - Long press button A for 5 seconds, the indicator light will blink. After 3 seconds of blinking, the receiver will enter into silent mode. Press either button A or B to exit silent mode.
- Select a melody - Short press button B on the side of the unit to cycle through 25 melodies. Unplug the unit to reset the unit to standard bell tone.
- Learn Mode - Short press button B on the side of the unit for 5 seconds until the indicator light C blinks to enter learn mode. Press the transmitter twice. The receiver will ring with indicator light blinking to confirm that the transmitter has been paired to the receiver. Door chime kit will exit learn mode automatically.

Adding an additional transmitter

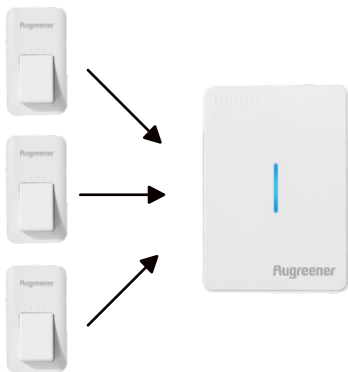

Follow the instructions for Learn Mode above then pair each additional transmitter to the receiver.

Note: Maximum of 3 transmitters can be connected to a single receiver.

Adding an additional receiver

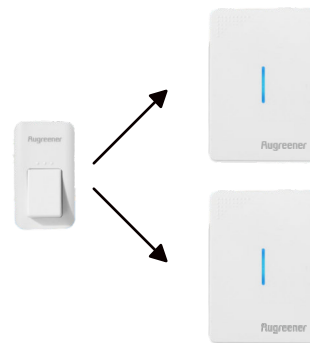

Follow the instructions for Learn Mode then pair each additional receiver to the transmitter.

Note: There is no limit to the number of receivers.

Trouble Shooting

Receiver does not sound	<ol style="list-style-type: none"> 1. Make sure the receiver is plugged in securely. 2. Make sure the transmitter has been synchronised correctly with receiver.
Indicator light is off	<ol style="list-style-type: none"> 1. Make sure the receiver is plugged in securely. 2. Ensure the receiver isn't in Learn Mode
Reduced Range	<ol style="list-style-type: none"> 1. Metal structures, including door frames can result in reduced transmission range. Avoid mounting transmitter or receiver on or near metal structures. 2. Other electric equipment can cause radio interference that affects your receiver. 3. Walls, doors and ceilings will reduce the range.



This product is classed as Electrical or Electronic equipment and should not be disposed with other household or commercial waste at the end of its useful life. The goods must be disposed of according to your local council guidelines.